



201 N. Champaign St. Bement, Illinois 61813

COMPRESSOR REPLACEMENT B17=75

Media Type: Cellulose

Max Working Pressure (psi): 175

Core Collapse Pressure (psid): 80

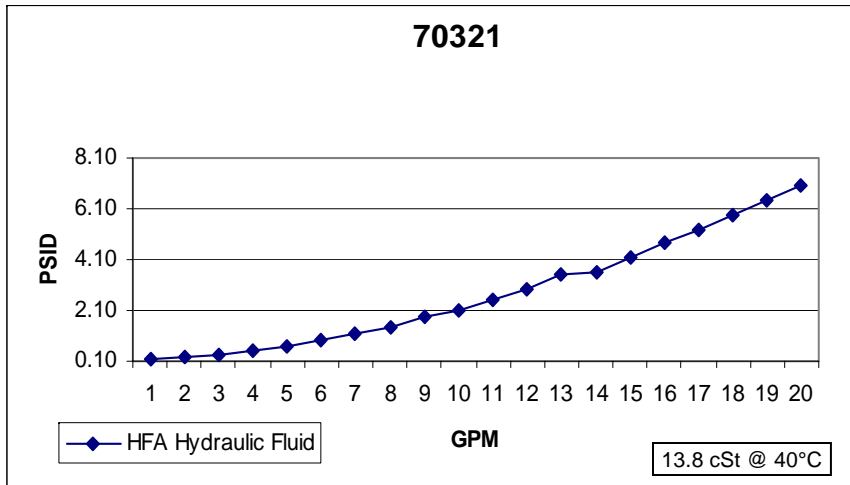

NOTES:

1. Technical Data subject to change without notice.
2. Tests are conducted with Mobile Aero HFA Aviation Hydraulic Fluid.
3. Filters are not to be used with aviation applications.

jw 02/16/09 Rev A

Technical Data Sheet - 70321

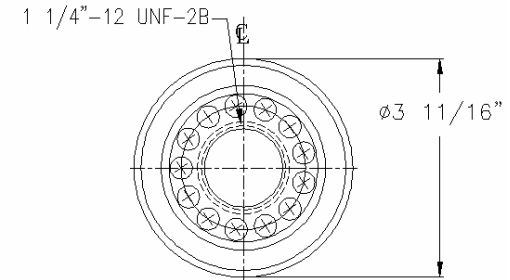

β4=2
 β6=3
 β14=34
 β17=75
 β28=200

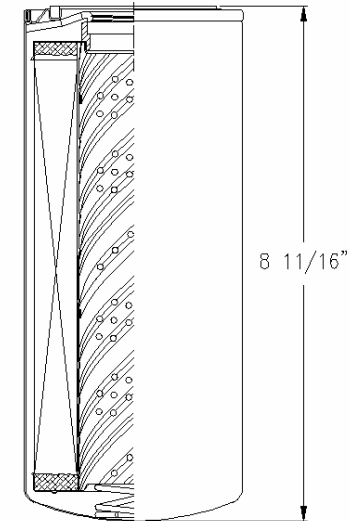

Gasket:

I. D. 2 13/32
 O. D. 2 25/32